

PART NR.
LT802

COUNTRY OF ORIGIN
Netherlands

STANDARDS
REACH and RoHS compliant
ECE E3 approved
IP66/68 protection

CHARACTERISTICS

- **Weight: 0,1 kg**

PHOTO / TECHNICAL DRAWING

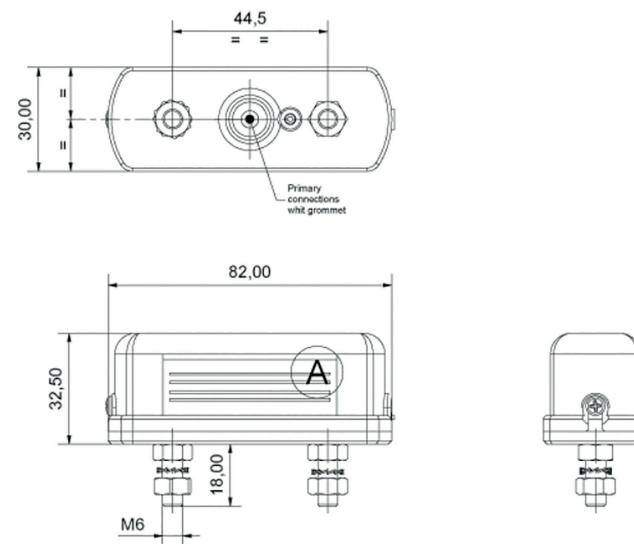

DIMENSIONS

L x B x H: 82 x 32,5 x 30 mm
Screw spacing: M6 bolts, spaced 44,5 mm

TECHNICAL SPECIFICATIONS

Light source: Bulb R10W (not included)
Rating: 12V