

**PART NR.**  
**LT916**

**COUNTRY OF ORIGIN**  
Turkey

**STANDARDS**  
REACH and RoHS compliant  
ECE and E9 approval

**CHARACTERISTICS**  
• With mounting bracket

## SIDE MARKER - BULB

### PHOTO / TECHNICAL DRAWING

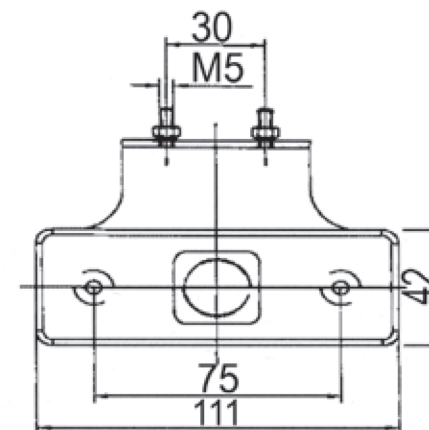

### DIMENSIONS

Marker L x B: 111 x 42 mm  
Hole spacing: 75 mm  
Hole spacing bracket: 30 mm

### TECHNICAL SPECIFICATIONS

Light source: Bulb W3W (T10) not included  
Reflector  
Mounting: M5 bolts and nuts  
Connection: Integrated ttr cable connector  
Rating: 12-24V