

**PART NR.**

See dimensions table

**COUNTRY OF ORIGIN:**

Taiwan

**STANDARDS:**

REACH and RoHS compliant

**PVC FLANGE SPADE TERMINAL - STRAIGHT COPPER SLEEVE**

**PHOTO / TECHNICAL DRAWING**

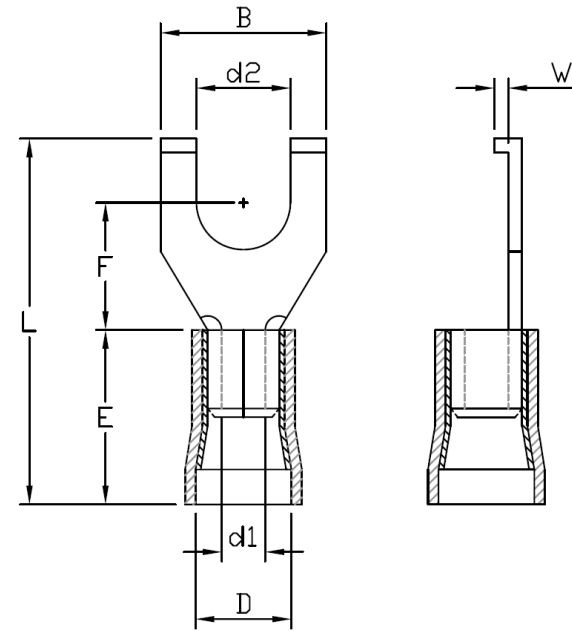

**DIMENSIONS**

| Wire range              | Part nr.  | d2  | B   | F   | L    | E    | D   | d1  | W   | UL |
|-------------------------|-----------|-----|-----|-----|------|------|-----|-----|-----|----|
| 16~14 AWG               | BFVD 2-4B | 4,3 | 7,2 | 6,5 | 21,2 | 10,0 | 5,1 | 2,3 | 1,5 |    |
| 1,5~2,5 mm <sup>2</sup> | BFVD 2-5B | 5,3 | 8,5 | 7,3 | 22,0 | 10,0 | 5,1 | 2,3 | 1,5 |    |

**TECHNICAL SPECIFICATIONS**

Terminal: Copper, tin plated  
Insulation: Vinyl (PVC)  
Operating temperature: -10~75 °C  
Max. electrical current: 600V  
Max. electrical rating: blue 27A