

# NYLON FEMALE DISCONNECTOR FULLY INSULATED - STANDARD

**PART NR.**

See dimensions table

**COUNTRY OF ORIGIN:**

Taiwan

**STANDARDS:**

REACH and RoHS compliant

Halogen free

UL listed

**PHOTO / TECHNICAL DRAWING**

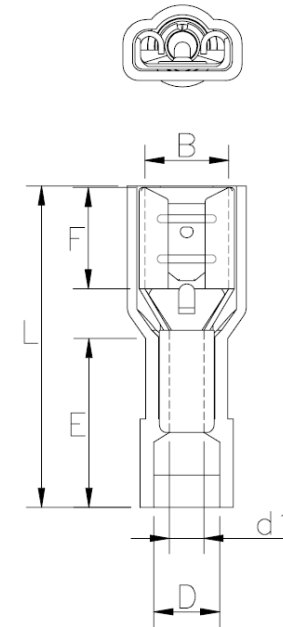
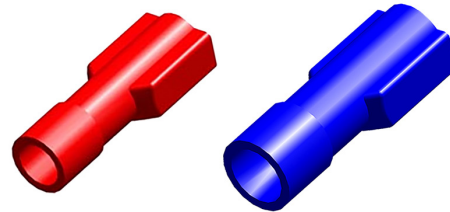

**DIMENSIONS**

Wire range	Part nr.	tab	B	F	L	E	D	d1	UL
22~16 AWG	ELNDF 1.25-187A5	4,8x0,5	5,0	6,4	20,0	10,5	4,2	1,7	✓
0,5~1,5 mm <sup>2</sup>	ELNDF 1.25-187A8	4,8x0,8	5,0	6,4	20,0	10,5	4,2	1,7	✓
16~14 AWG	ELNDF 2-187A5	4,8x0,5	5,0	6,4	20,0	10,5	4,9	2,3	✓
1,5~2,5 mm <sup>2</sup>	ELNDF 2-187A8	4,8x0,8	5,0	6,4	20,0	10,5	4,9	2,3	✓

**TECHNICAL SPECIFICATIONS**

Terminal:	Brass, tin plated
Insulation:	Nylon (PA 66)
Operating temperature:	-40~105 °C
Max. electrical current:	300V
Max. electrical rating:	red 10A blue 15A