

NYLON FEMALE DISCONNECTOR FULLY INSULATED - EASY ENTRY

PART NR.

See dimensions table

COUNTRY OF ORIGIN:

Taiwan

STANDARDS:

REACH and RoHS compliant

Halogen free

UL listed

PHOTO / TECHNICAL DRAWING

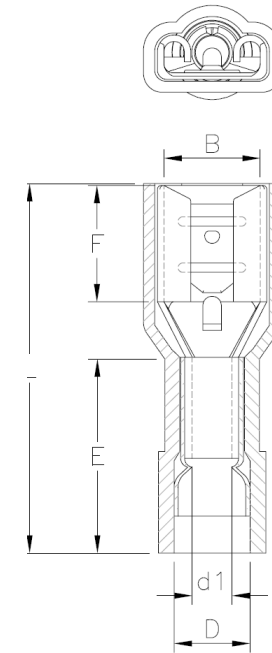
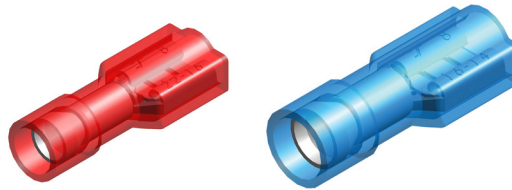

DIMENSIONS

Wire range	Part nr.	tab	B	F	L	E	D	d1	UL
22~16 AWG	ELNDDF 1.25-187A5	4,8x0,5	5,0	6,4	20,0	10,5	4,2	1,7	✓
0,5~1,5 mm ²	ELNDDF 1.25-187A8	4,8x0,8	5,0	6,4	20,0	10,5	4,2	1,7	✓
16~14 AWG	ELNDDF 2-187A5	4,8x0,5	5,0	6,4	20,0	10,5	4,9	2,3	✓
1,5~2,5 mm ²	ELNDDF 2-187A8	4,8x0,8	5,0	6,4	20,0	10,5	4,9	2,3	✓

TECHNICAL SPECIFICATIONS

Terminal:	Brass, tin plated
Insulation:	Nylon (PA 66)
Operating temperature:	-40~105 °C
Max. electrical current:	300V
Max. electrical rating:	red 10A blue 15A