

# NYLON FEMALE DISCONNECTOR FULLY INSULATED - EASY ENTRY

**PART NR.**  
See dimensions table

**COUNTRY OF ORIGIN:**  
Taiwan

**STANDARDS:**  
REACH and RoHS compliant  
Halogen free

UL listed

## PHOTO / TECHNICAL DRAWING

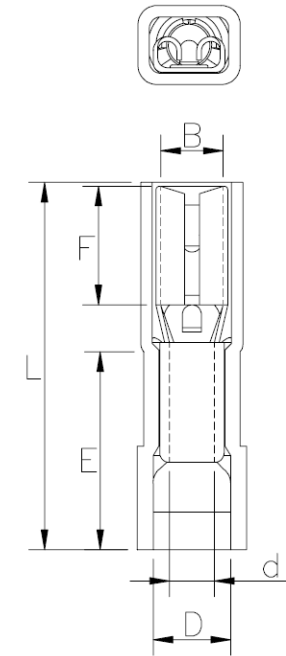

## DIMENSIONS

Wire range	Part nr.	tab	B	F	L	E	D	d1	UL
22~16 AWG	ELNDDF 1.25-110A5	2,8x0,5	3,2	6,4	19,5	10,5	4,2	1,7	✓
0,5~1,5 mm <sup>2</sup>	ELNDDF 1.25-110A8	2,8x0,8	3,2	6,4	19,5	10,5	4,2	1,7	✓

## TECHNICAL SPECIFICATIONS

Terminal:	Brass, tin plated
Insulation:	Nylon (PA 66)
Operating temperature:	-40~105 °C
Max. electrical current:	300V
Max. electrical rating:	red 10A