

PART NR.
See rating table

COUNTRY OF ORIGIN
Japan

STANDARDS
REACH and RoHS compliant
DIN ISO 8820-5

CHARACTERISTICS

- Meets international specs, complies to ISO 8820-5, JASO D612 and other standards
- Element visibility through viewing window
- PA6T housing, heat & chemical resistant
- Rigid Sn plated copper alloy blades
- Color coded housing, marked with amperage rating
- M6 connection holes, spaced 30 mm
- Maximum torque 4.5Nm ± 1 Nm

mediOTO BOLT-ON FUSE - OBFMDP SERIES 58V

PHOTO / TECHNICAL DRAWING

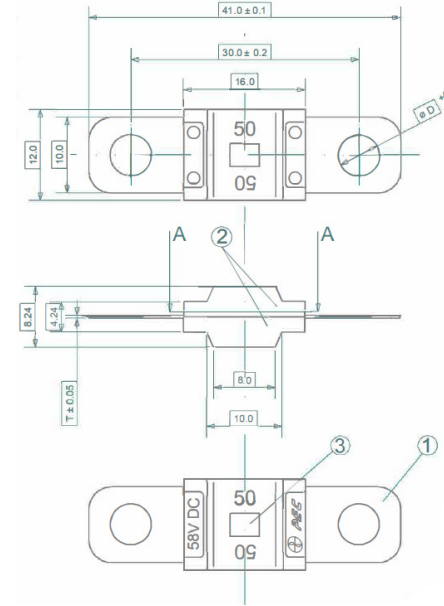
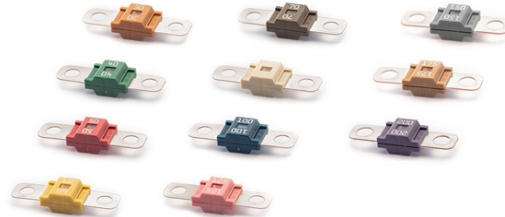

- 1 - element
- 2 - housing
- 3 - window

L x W x H: 16 (+25) x 12 x 8,24 mm

DIMENSIONS

RATING TABLE

Part nr.	Hole size	Color	Rating (A)	Rating (V)
OBFMDP030	M5	orange	30	58
OBFMDP040	M5	green	40	58
OBFMDP050	M5	red	50	58
OBFMDP060	M5	yellow	60	58
OBFMDP070	M5	brown	70	58
OBFMDP080	M5	white	80	58
OBFMDP100	M5	blue	100	58
OBFMDP125	M5	pink	125	58
OBFMD030M6	M6	orange	30	58
OBFMD040M6	M6	green	40	58
OBFMD050M6	M6	red	50	58
OBFMD060M6	M6	yellow	60	58
OBFMD070M6	M6	brown	70	58
OBFMD080M6	M6	white	80	58
OBFMD100M6	M6	blue	100	58
OBFMD125M6	M6	pink	125	58
OBFMD150M6	M6	grey	150	58
OBFMD175M6	M6	tan	175	58
OBFMD200M6	M6	violet	200	58

TECHNICAL SPECIFICATIONS

Body: PA6T, color coded
 Window: PAR
 Element: Cu alloy, Sn plated
 Hole size: M5 OR M6 spaced 30 mm
 Max. torque: 4,5 ± 1 Nm