

CORD END TERMINAL - NON-INSULATED

PART NR.
See dimensions table

COUNTRY OF ORIGIN
Germany

STANDARDS
REACH and RoHS compliant
DIN 46228/1
Compliant to EU directives 2002/96/EC (WEEE),
2002/95/EC (ROHS) AND 2003/11/CE

PHOTO / TECHNICAL DRAWING

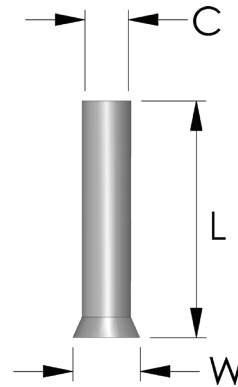

DIMENSIONS

Wire range	Part nr.	L	C	W	Packed	UL
0,14 mm ²	AH 0.14*	7,0	0,65	1,6	1000	
0,25 mm ²	AH 0.25K*	5,0	0,75	1,7	1000	
	AH 0.25*	7,0	0,75	1,7	1000	
	AH 0.25L*	10,0	0,75	1,7	1000	
0,34 mm ²	AH 0.34K*	5,0	0,85	1,8	1000	
	AH 0.34*	7,0	0,85	1,8	1000	
0,5 mm ²	AH 0.50KK*	6,0	1,0	2,1	1000	✓
	AH 0.50K*	8,0	1,0	2,1	1000	✓
	AH 0.50*	10,0	1,0	2,1	1000	✓
0,75 mm ²	AH 0.75KK*	6,0	1,2	2,3	1000	✓
	AH 0.75K*	8,0	1,2	2,3	1000	✓
	AH 0.75*	10,0	1,2	2,3	1000	✓
	AH 0.75HL*	12,0	1,2	2,3	1000	✓
1 mm ²	AH 1.00KK*	6,0	1,4	2,5	1000	✓
	AH 1.00K*	8,0	1,4	2,5	1000	✓
	AH 1.00*	10,0	1,4	2,5	1000	✓
	AH 1.00HL*	12,0	1,4	2,5	1000	✓
1,5 mm ²	AH 1.50KK*	7,0	1,7	2,8	1000	✓
	AH 1.50K*	8,0	1,7	2,8	1000	✓
	AH 1.50*	10,0	1,7	2,8	1000	✓
	AH 1.50HL*	12,0	1,7	2,8	1000	✓
2,5 mm ²	AH 2.50KK*	7,0	2,2	3,4	1000	✓
	AH 2.50K*	8,0	2,2	3,4	1000	✓
	AH 2.50*	10,0	2,2	3,4	1000	✓
	AH 2.50HL*	12,0	2,2	3,4	1000	✓
	AH 2.50L*	18,0	2,2	3,4	1000	✓
4,0 mm ²	AH 4.00K*	9,0	2,8	4,0	1000	✓
	AH 4.00N*	10,0	2,8	4,0	1000	✓
	AH 4.00*	12,0	2,8	4,0	1000	✓
	AH 4.00HL*	15,0	2,8	4,0	1000	✓
	AH 4.00L*	18,0	2,8	4,0	1000	✓

Continue on the next page

TECHNICAL SPECIFICATIONS

Terminal: Red copper (Cu-ETP),
electro tin plated
Min. coating thickness: 3 µm

Wire range	Part nr.	L	C	W	Packed	UL
6 mm ²	AH 6.00K*	10,0	3,5	4,7	250	✓
	AH 6.00HL*	12,0	3,5	4,7	250	✓
	AH 6.00*	15,0	3,5	4,7	250	✓
	AH 6.00L*	18,0	3,5	4,7	250	✓
10 mm ²	AH 10.00K*	12,0	4,5	5,8	250	✓
	AH 10.00*	15,0	4,5	5,8	250	✓
	AH 10.00L*	18,0	4,5	5,8	250	✓
16 mm ²	AH 16.00K*	12,0	5,8	7,5	250	✓
	AH 16.00*	15,0	5,8	7,5	250	✓
	AH 16.00HL*	18,0	5,8	7,5	250	✓
	AH 16.00L*	25,0	5,8	7,5	250	✓
25 mm ²	AH 25.00KK*	12,0	7,3	9,5	250	✓
	AH 25.00K*	15,0	7,3	9,5	250	✓
	AH 25.00*	18,0	7,3	9,5	250	✓
	AH 25.00HL*	25,0	7,3	9,5	250	✓
	AH 25.00L*	32,0	7,3	9,5	250	✓
35 mm ²	AH 35.00K	12,0	8,3	11,0	100	✓
	AH 35.00	18,0	8,3	11,0	100	✓
	AH 35.00HL	20,0	8,3	11,0	100	✓
	AH 35.00L	25,0	8,3	11,0	100	✓
50 mm ²	AH 50.00K	18,0	10,3	13,0	100	✓
	AH 50.00	22,0	10,3	13,0	100	✓
	AH 50.00HL	25,0	10,3	13,0	100	✓
	AH 50.00L	32,0	10,3	13,0	100	✓
70 mm ²	AH 70.00HL	25,0	12,5	15,0	100	
	AH 70.00L	32,0	12,5	15,0	100	
95 mm ²	AH 95.00HL	25,0	14,5	17,0	50	
	AH 95.00L	32,0	14,5	17,0	50	
120 mm ²	AH 120.00HL	32,0	16,5	19,0	50	
150 mm ²	AH 150.00HL	32,0	18,5	21,0	50	
	AH 150.00L	38,0	18,5	21,0	50	

* Also available in 100 pcs bags